

# Tube bending machine RB 15

The machine can be used for the efficient and accurate bending of copper, brass, steel and stainless steel tubes, cold and without filling. The machine is portable and simple to clamp in any bench vice.

## Special advantages

- Bending tight radii
- Possibility for bending in both directions (to the left or right)
- Bending with or without mandrel
- Angle of bend read from a scale
- Angle stop for series working
- Cam lock clamping (rational – fast)
- Simple, rapid setting up



## Standard bending tool (cam lock clamping)

The most common bending work can be carried out with the standard bending tool type NB. Bends can be produced in both directions, i.e. to the left and right. This enables successive bends to be made at different levels, the only restriction is that for clamping, the straight intermediate section must be at least 50 mm long. The tube is clamped by the cam lock clamping supplied with the machine.

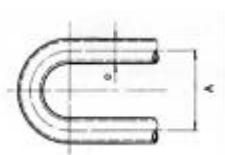

tube? mm	Standard bending tool			
	Designation	Bend-? mm	= 2 x bending radius	
6	6	NB 20	20	2 x 10
6,35 (1/4")	6, 35	NB 20	20	2 x 10
8	8	NB 24	24	2 x 12
9,52 (3/8")	9,52	NB 30	30	2 x 15
10	10	NB 30	30	2 x 15
12	12	NB 36	36	2 x 18
12,7 (1/2")	12,7	NB 36	36	2 x 18
14	14	NB 42	42	2 x 21
15	15	NB 45	45	2 x 22,5
16	16	NB 48	48	2 x 24
17	17	NB 51	51	2 x 25,5
18	18	NB 54	54	2 x 27

Please inquire concerning tool sizes not listed, also special tools.

Standard mandrels for tube internal ? 4, 5, 6, 7, 8, 9, 10, 11, 12 & 13 mm.



Ball mandrels for thin-walled tubes of copper, brass and aluminium. For tube internal ? 10, 11, 12, 13, 14, 15 & 16 mm.



For stainless tubes, ask for hard chrome-plated mandrels.

## Principal data

Max. bend ? (= 2 x bending radius R 80 mm)	160 mm
Max. angle of bend	180 °
Max. tube length up to start of bend when bending with mandrel	500 mm
Machine dimension	667 x 430 x 114 mm
Weight	22 kg

Max. bending performance	Steel tube	15 x 1,5
	Stainless steel tube	15 x 1,5
	Copper tube	18 x 1,5
	Brass tube	18 x 1,5
	Aluminium tube	15 x 2,0
	Solid material	? 12



## Universal bending tool (clamping with stap)

The universal bending tool type UB has two possibilities for tube clamping: For normal, simple bending, fast clamping can take place using the cam lock clamping; on the other hand, space-saving strap clamping can be used for bends occurring in quick succession. So in addition to the bending possibilities of the standard bending tool, the type of tool can also be used for successive bends with any intermediate section at levels displaced by 90 °, also up to tube ? 10 mm, additionally, bends at the same level (S-bends)-

Universal bending tools = ~ 5 x tube? D

tube ? mm	Universal bending tool			
	Designation	Bend-? mm	= 2 x Bending radius	
6	6 UB 32	32	2 x 16	
6,35 (1/4")	6, 35 UB 32	32	2 x 16	
8	8 UB 40	40	2 x 20	
9,52 (3/8")	9,52 UB 50	50	2 x 25	
10	10 UB 50	50	2 x 25	
12	12 UB 60	60	2 x 30	
12,7 (1/2")	12,7 UB 60	60	2 x 30	
14	14 UB 70	70	2 x 35	
15	15 UB 75	75	2 x 37,5	
16	16 UB 80	80	2 x 40	
17	17 UB 80	80	2 x 40	
18	18 UB 80	80	2 x 40	

